



Eagle Realty USA

FOR SALE

**2 W. St. George Ave, Linden
(Union County), NJ**



- **Property Size +/- 0.22 Acres**
- **Zoned: C-2**
- **Traffic Counts:**
 - **Wood Ave: 18,000 ADT**
 - **St George Ave: 24,520 ADT**
- **Taxes (2013): \$16,748.57**
- **Building Size: +/- 300 sq ft**
- **Current Use: Gas Station**
- **Area Retailers Include:**



- **Asking Price: Call for Details**
- **Property includes a leasehold interest**

Eagle Realty USA

Licensed Real Estate Broker

410 Route 10 West

Ledgewood, NJ 07852

"We Close Deals... That's the Bottom Line"

For More Information Please Contact:

Michael D. Clark

Sales-Associate

973-598-1500 Ext 13

973-214-1798

Mike@EagleRealtyUSA.net

Gary J. Drechsel, Sr.

Member—Broker of Record

973-598-1500 Ext 11

973-713-7700

Gary@EagleRealtyUSA.net

All information is from sources deemed reliable but is not guaranteed and is subject to errors, omissions, change of price and / or terms, prior sale, lease or withdrawal without notice. Broker is not liable for the accuracy of any information provided herein, and all information should be independently verified prior to entering into any binding agreements.



Eagle Realty USA

Rent Projections

2 W St George Ave, Linden, NJ

<u>Linden - Estimated Rent Projection</u>			
Property	2 W St Georges Ave, Linden, NJ		
Lease Expiration	10/31/2016	3, 5 yr options remain	
Current Rent	\$ 53,275.80	\$ 4,439.65	
Increases	15%	Per the current lease, increases are CPI and 15 % is an estimate based off previous increases to the lease.	
Cap Rate	6%-10%		
<u>Term</u>	<u>Rent</u>		
1	\$ 53,275.80		
2	\$ 53,275.80		
3	\$ 61,267.17	Renewal Option	
4	\$ 61,267.17		
5	\$ 61,267.17		
6	\$ 61,267.17		
7	\$ 61,267.17		
8	\$ 70,457.25	Renewal Option	
9	\$ 70,457.25		
10	\$ 70,457.25		
11	\$ 70,457.25		
12	\$ 70,457.25		
13	\$ 81,025.83	Renewal Option	
14	\$ 81,025.83		
15	\$ 81,025.83		
16	\$ 81,025.83		
17	\$ 81,025.83		
Total	\$ 1,170,302.84	Average Rent	\$ 68,841.34

All information is from sources deemed reliable but is not guaranteed and is subject to errors, omissions, change of price and / or terms, prior sale, lease or withdrawal without notice. Broker is not liable for the accuracy of any information provided herein, and all information should be independently verified prior to entering into any binding agreements.



Eagle Realty USA

Site Photo

2 W St George Ave, Linden, NJ



All information is from sources deemed reliable but is not guaranteed and is subject to errors, omissions, change of price and / or terms, prior sale, lease or withdrawal without notice. Broker is not liable for the accuracy of any information provided herein, and all information should be independently verified prior to entering into any binding agreements.



Eagle Realty USA

AERIAL

2 W St George Ave, Linden, NJ



All information is from sources deemed reliable but is not guaranteed and is subject to errors, omissions, change of price and / or terms, prior sale, lease or withdrawal without notice. Broker is not liable for the accuracy of any information provided herein, and all information should be independently verified prior to entering into any binding agreements.



Eagle Realty USA

Tax Map

2 W St George Ave, Linden, NJ

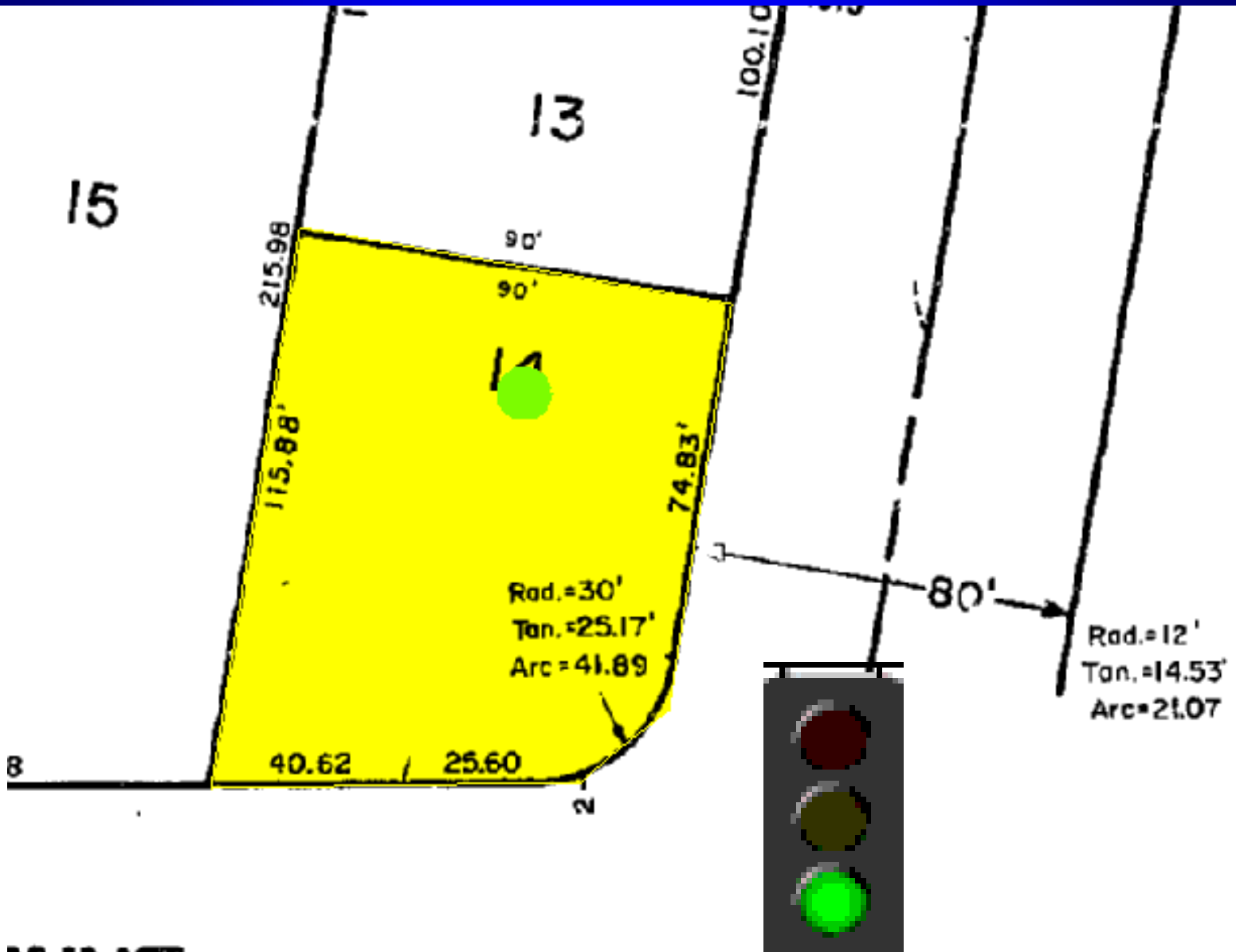

INUE

All information is from sources deemed reliable but is not guaranteed and is subject to errors, omissions, change of price and / or terms, prior sale, lease or withdrawal without notice. Broker is not liable for the accuracy of any information provided herein, and all information should be independently verified prior to entering into any binding agreements.



Eagle Realty USA

TRAFFIC COUNT MAP

2 W St. George Ave, Linden, NJ

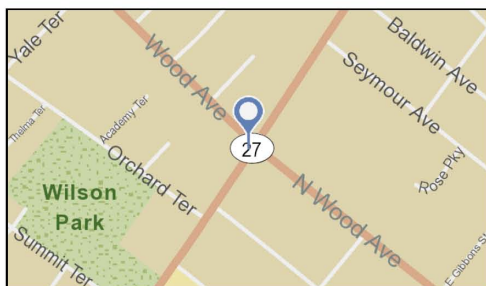

Average Daily Traffic Volume

- ▲ Up to 6,000 vehicles per day
- ▲ 6,001 - 15,000
- ▲ 15,001 - 30,000
- ▲ 30,001 - 50,000
- ▲ 50,001 - 100,000
- ▲ More than 100,000 per day

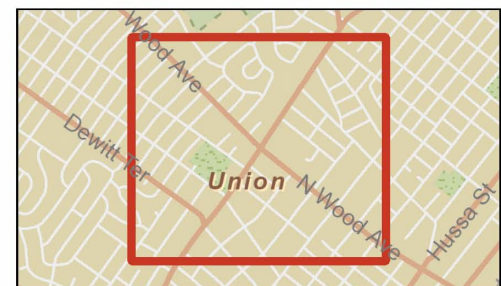

All information is from sources deemed reliable but is not guaranteed and is subject to errors, omissions, change of price and / or terms, prior sale, lease or withdrawal without notice. Broker is not liable for the accuracy of any information provided herein, and all information should be independently verified prior to entering into any binding agreements.